

everX Posterior™ Technique Guide



FIBER REINFORCED COMPOSITE FOR DENTIN REPLACEMENT

Prior to use, carefully read the instructions for use.

Class I cavities

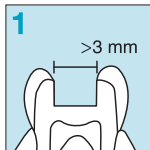

Prepare cavity

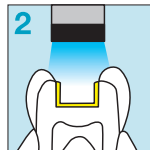

Bond and
light-cure

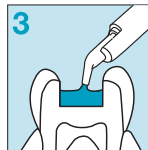

Place
everX Posterior

Class II and large cavities



Build first the missing walls by using light-curing restorative composite. The wall should be thick enough to withstand the application pressure of everX Posterior.

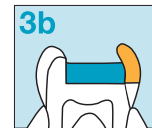

| Irradiation Time and Effective Depth of Cure (ISO 4049) | | |
|--|------------------|---------------|
| Curing device | Irradiation Time | Depth of cure |
| Plasma arc (2000 mW/cm ²) | 9 sec. | 4 mm |
| High Power LED Light (>1200 mW/cm ²) | 10 sec. | 4 mm |
| Halogen/ Normal LED Light (700 mW/cm ²) | 20 sec. | 4 mm |
| Note: Lower light intensity may cause insufficient curing or discoloration of the material. | | |

STORAGE

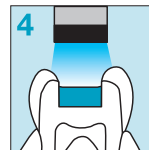

Light-cure

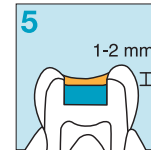

Cover with
composite

13006884
201221DK